

2019 AST  
ASHE  
COUNTY

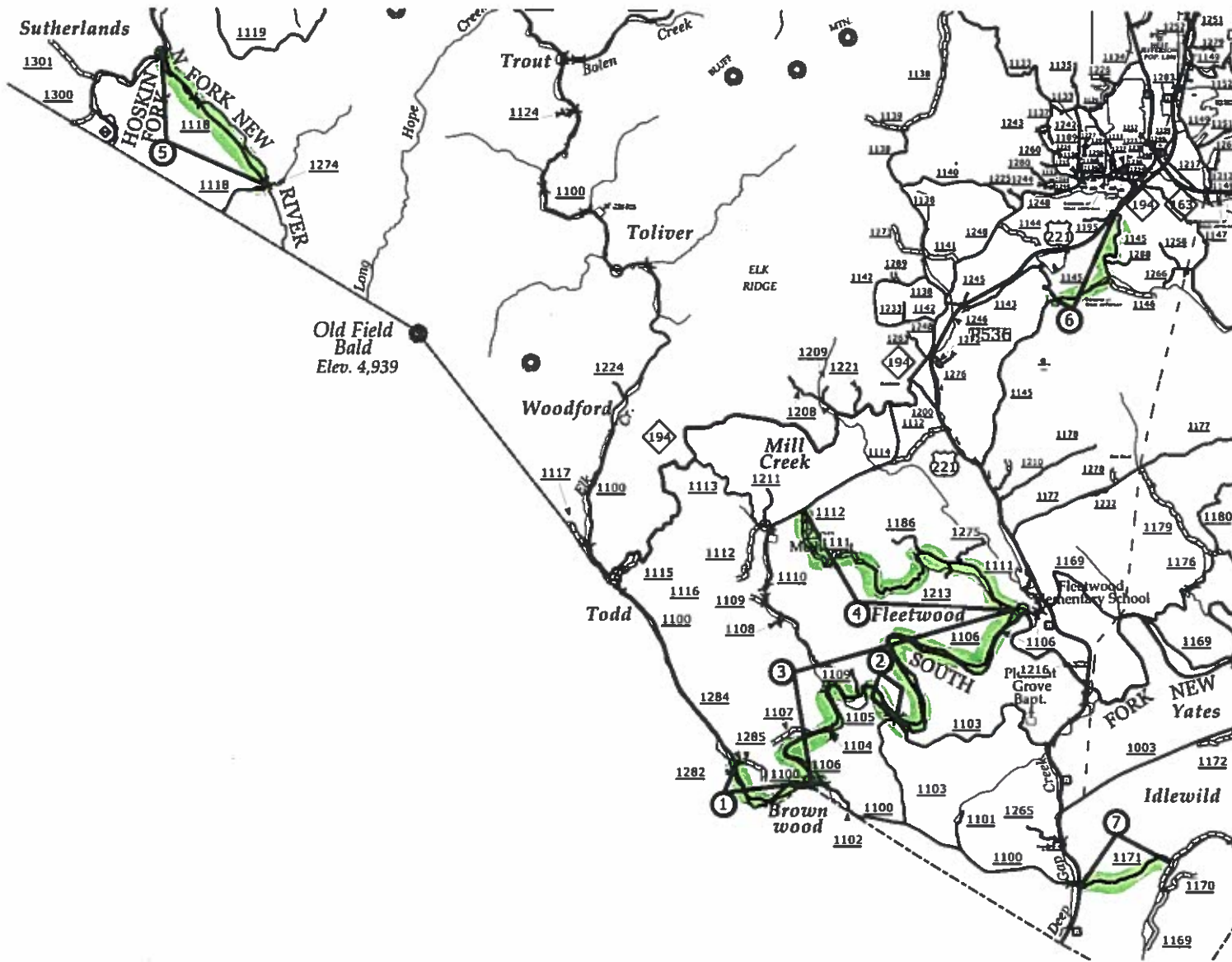

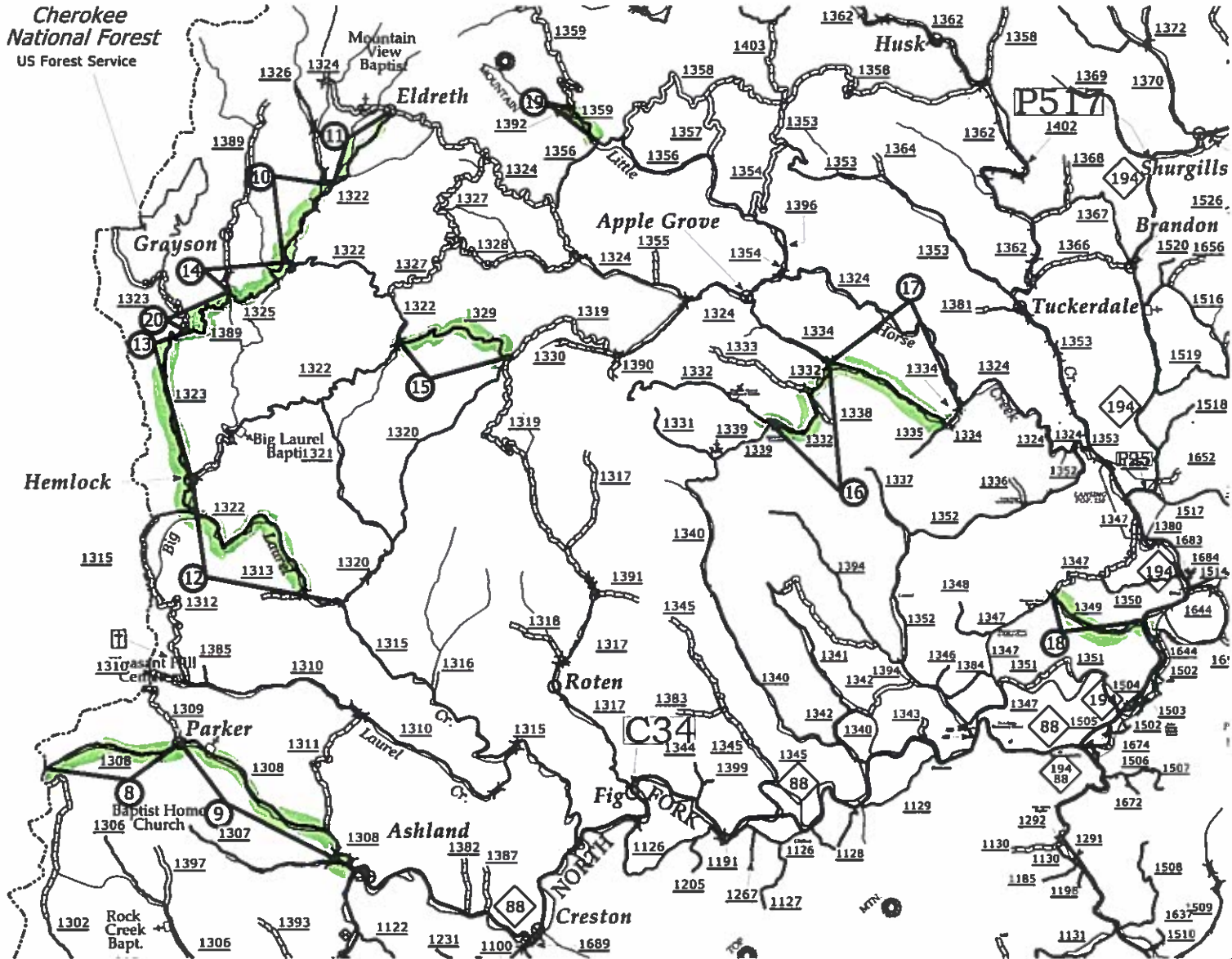

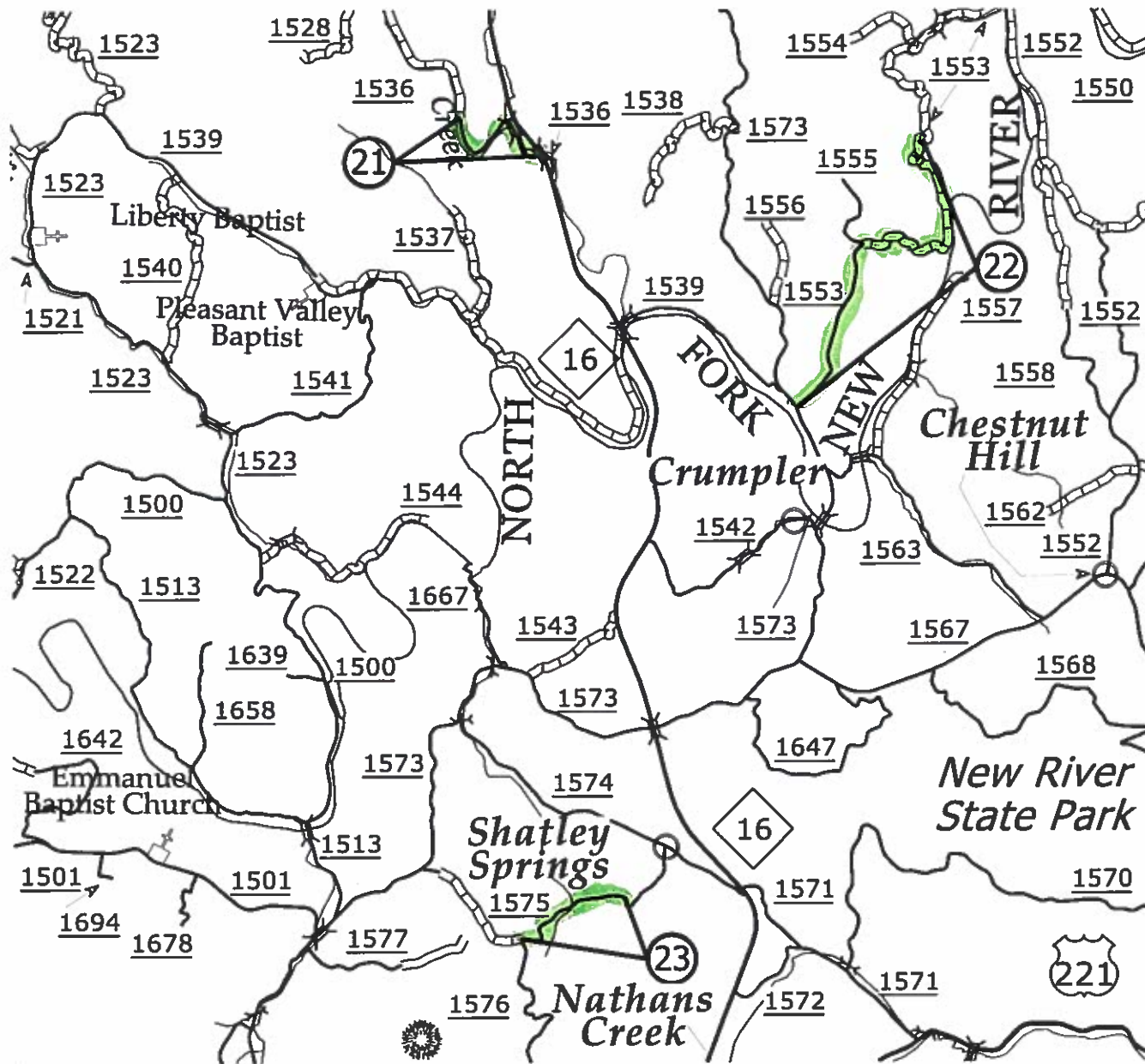





2019 AST  
WILKES COUNTY

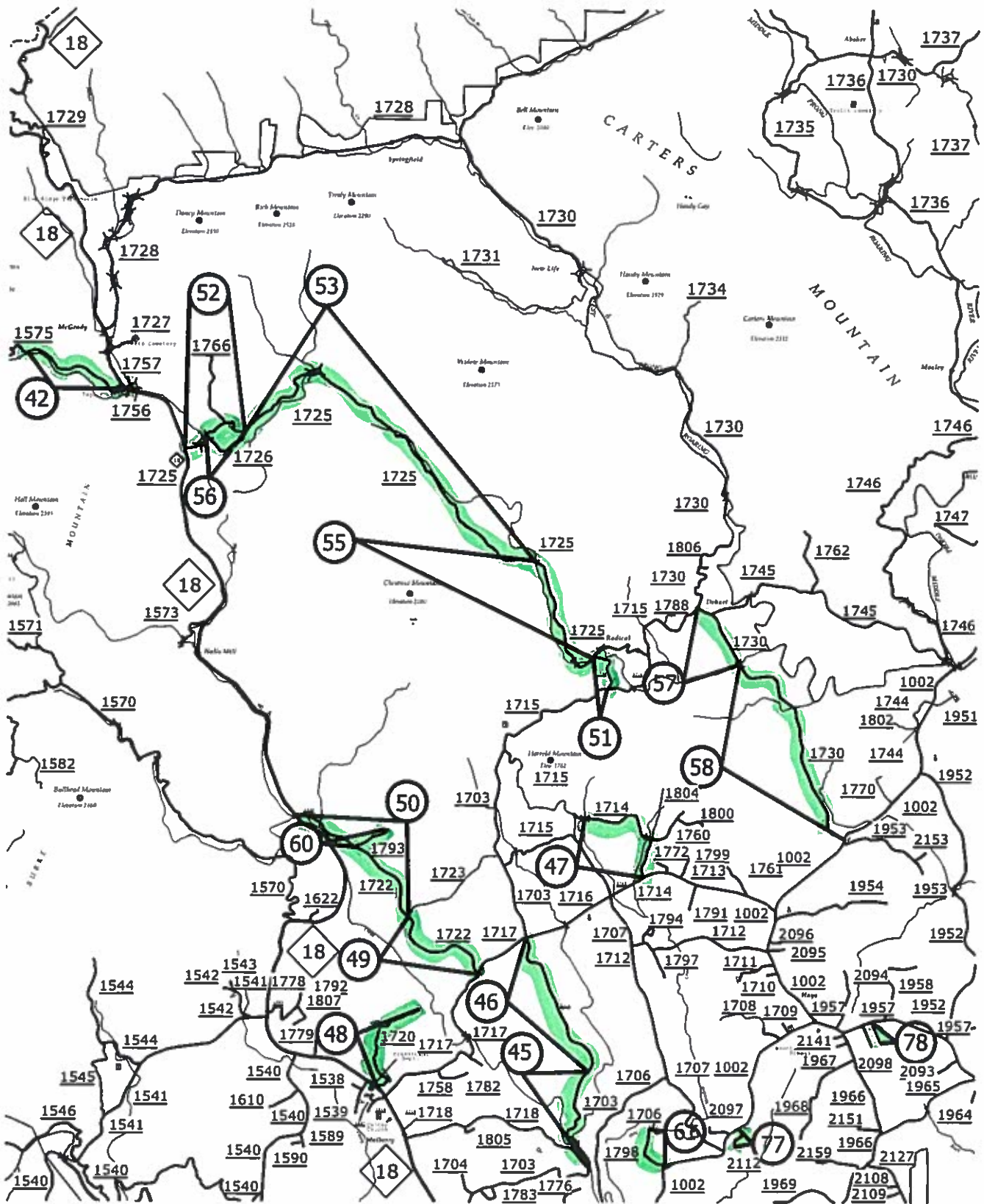

2019 AST  
WILKES COUNTY

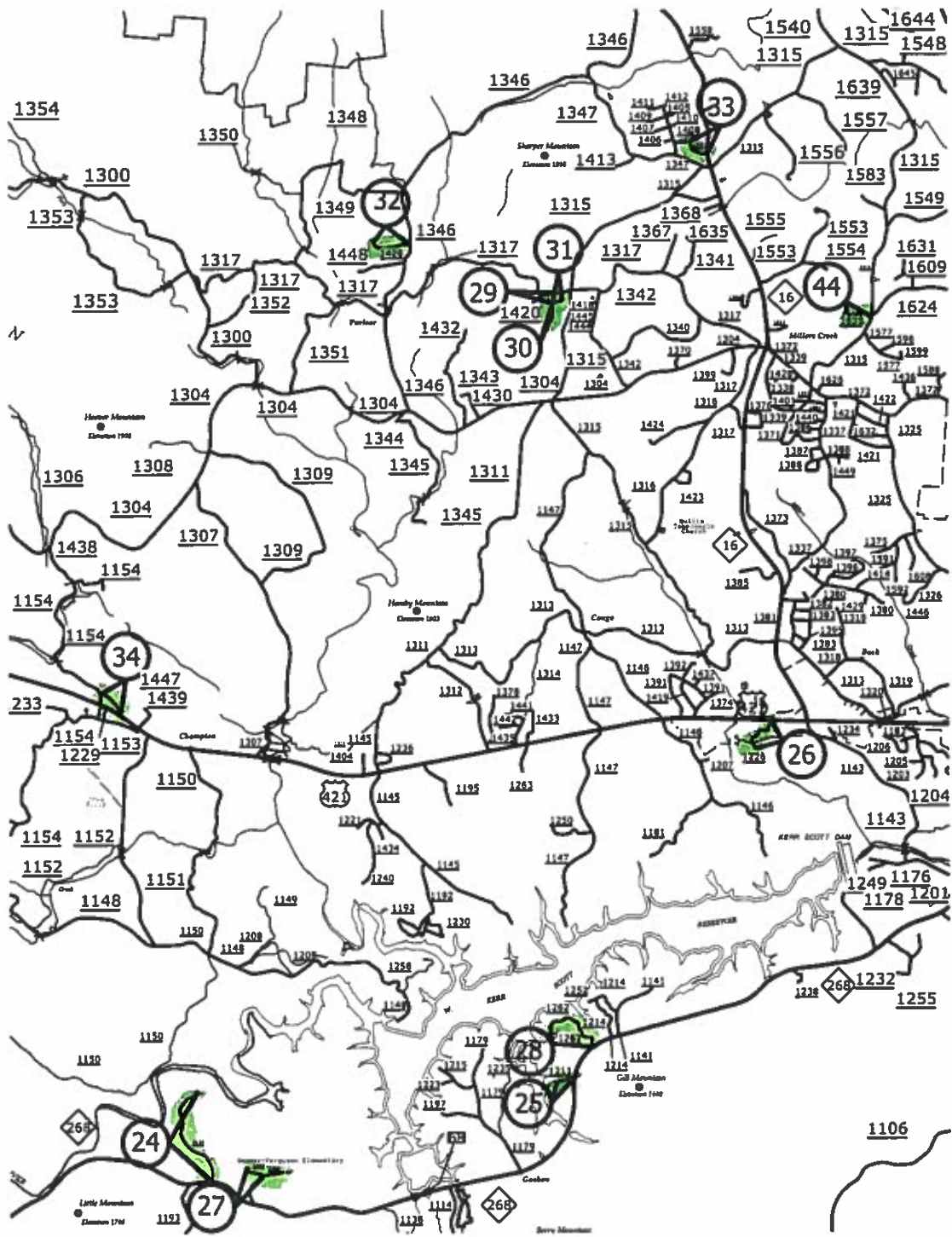

2019 AST  
WILKES COUNTY

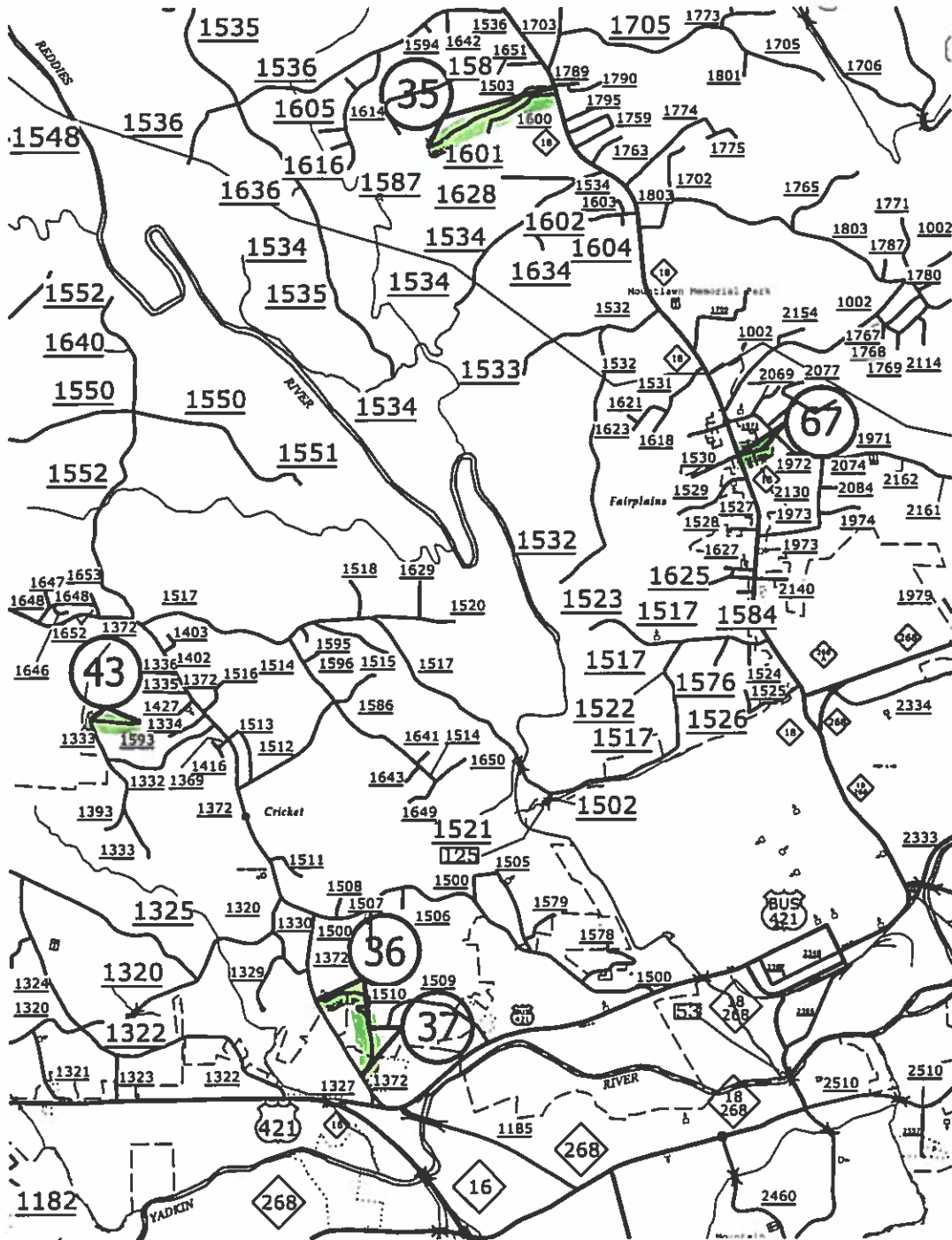

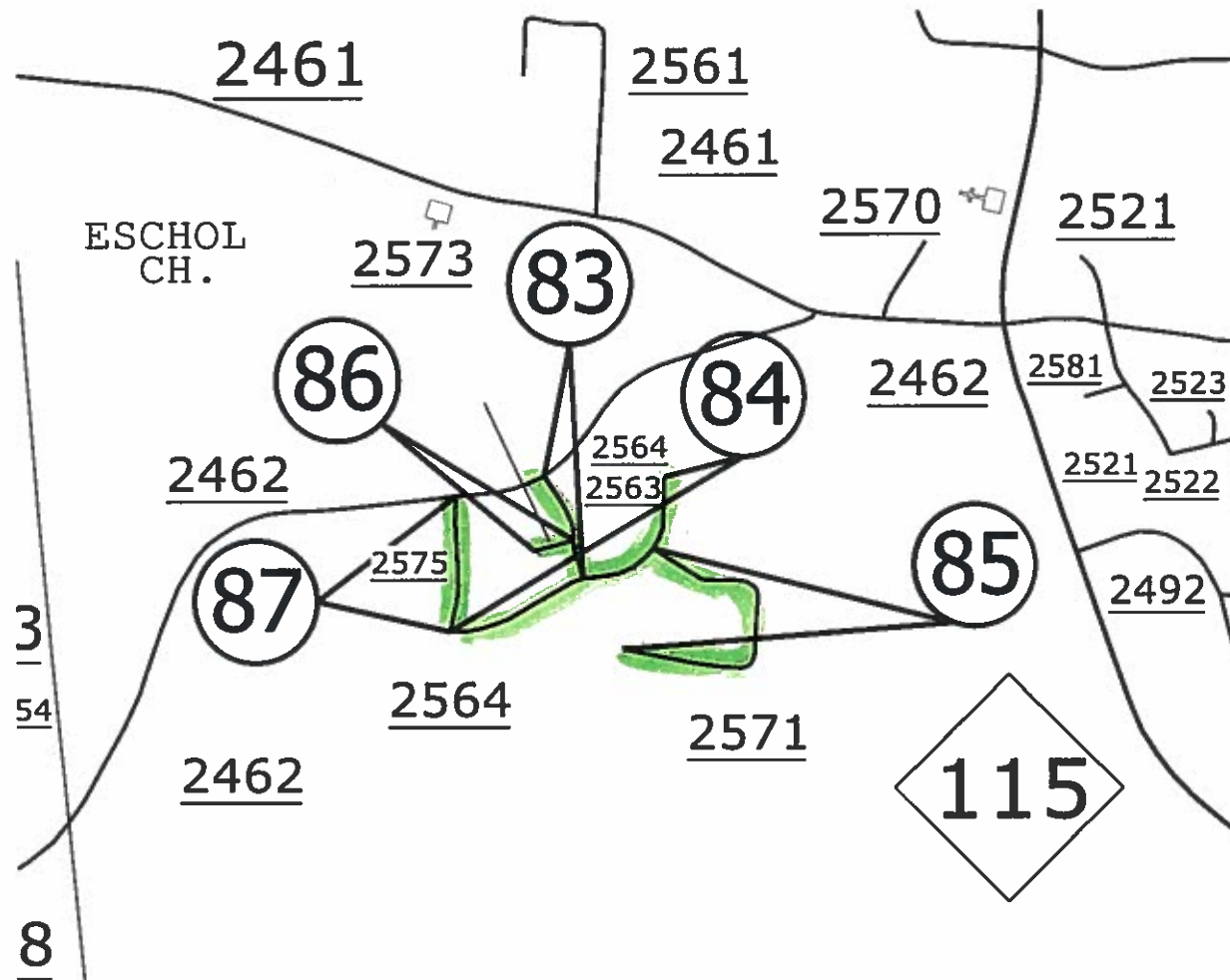





2019 AST  
WILKES COUNTY

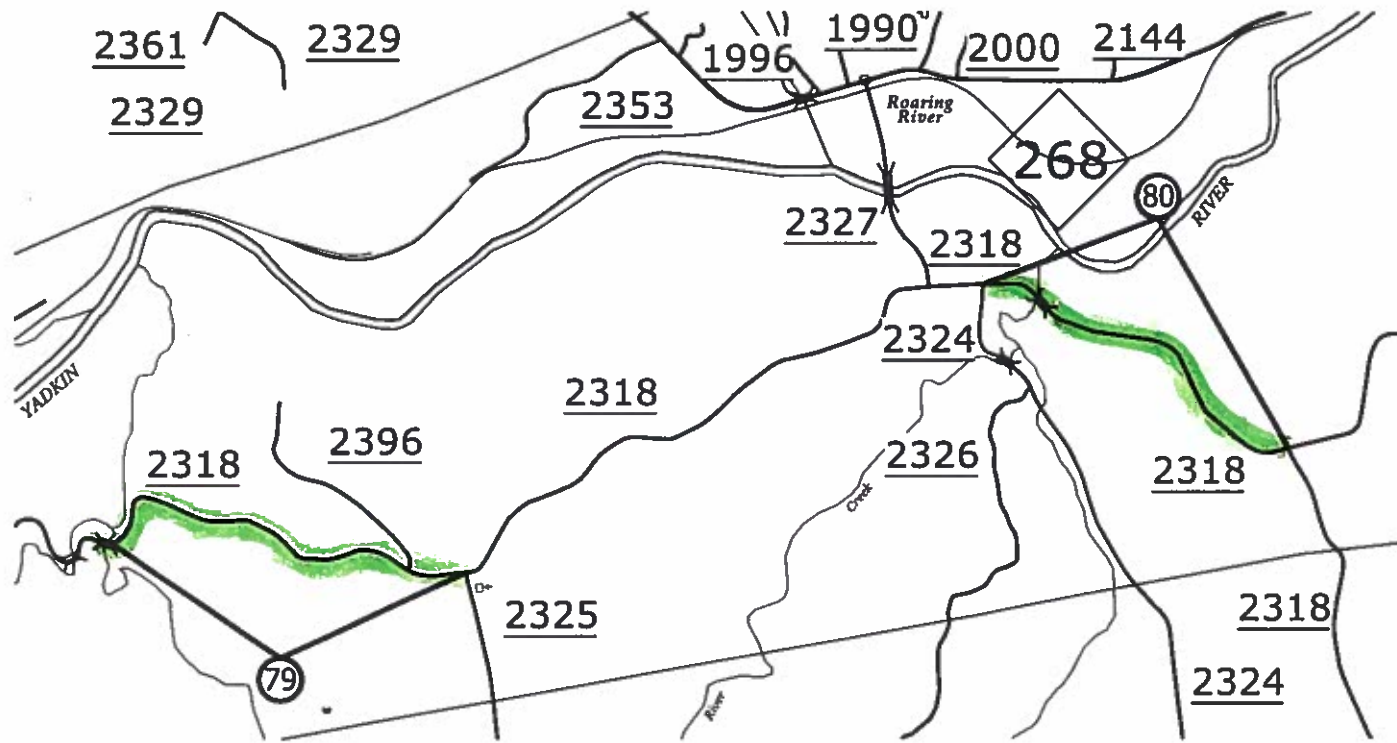

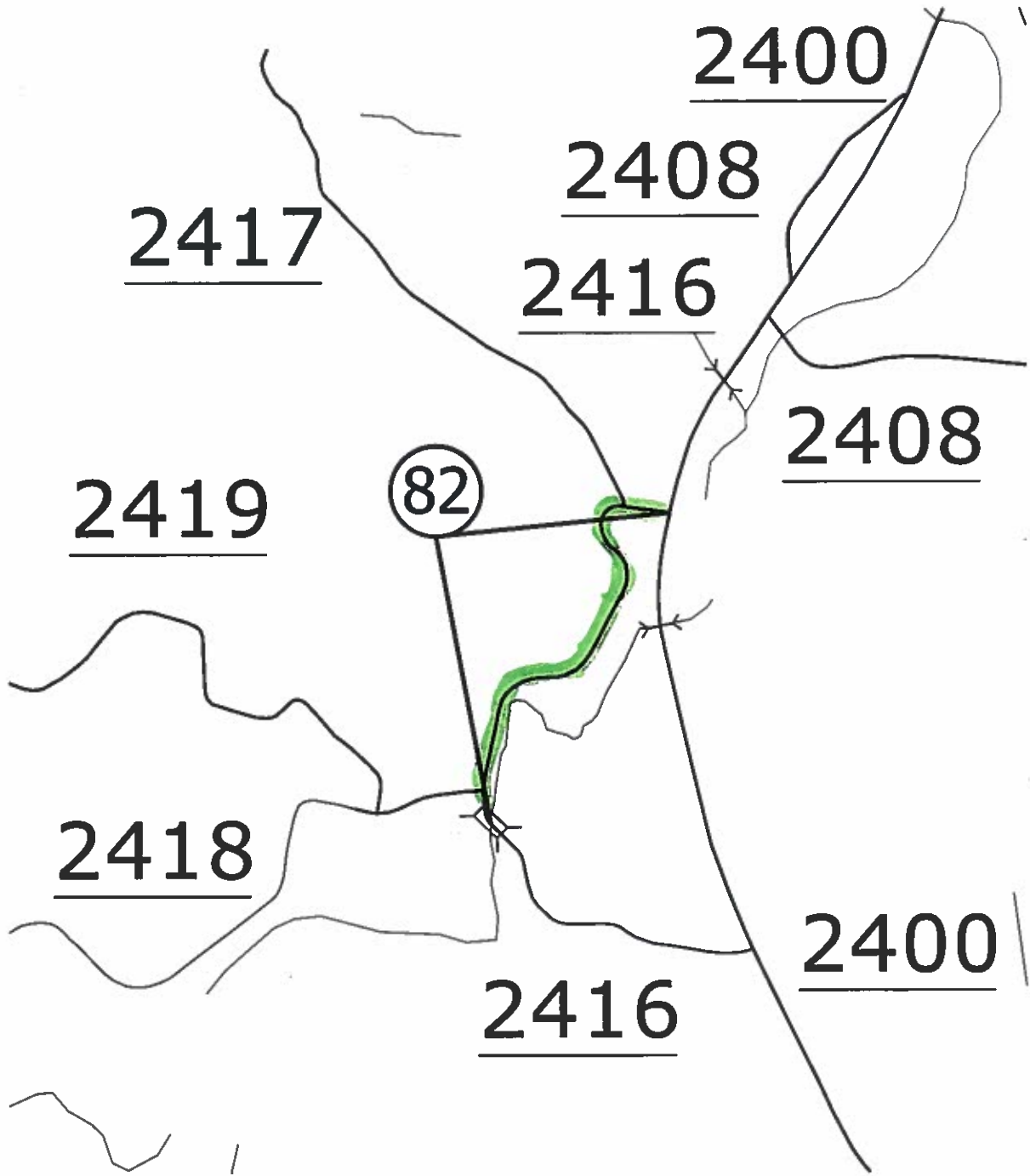

2019 AST  
WILKES COUNTY

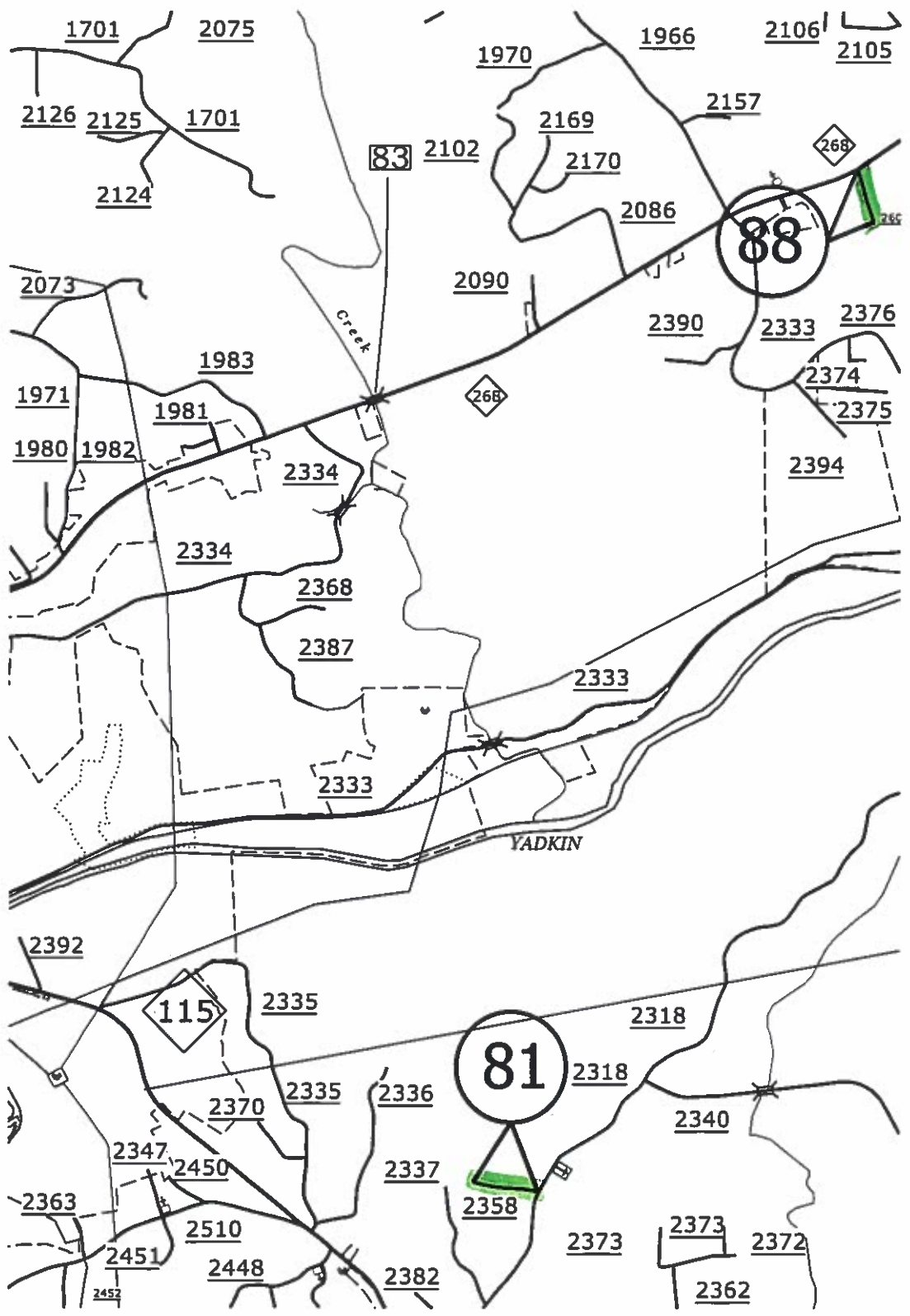



PAVEMENT SCHEDULE	
C1	PROP. ASPHALT SURFACE TREATMENT, TRIPLE SEAL
C2	PROP. ASPHALT SURFACE TREATMENT, DOUBLE SEAL
C3	PROP. ASPHALT SURFACE TREATMENT, SLURRY SEAL
U	EXISTING PAVEMENT.

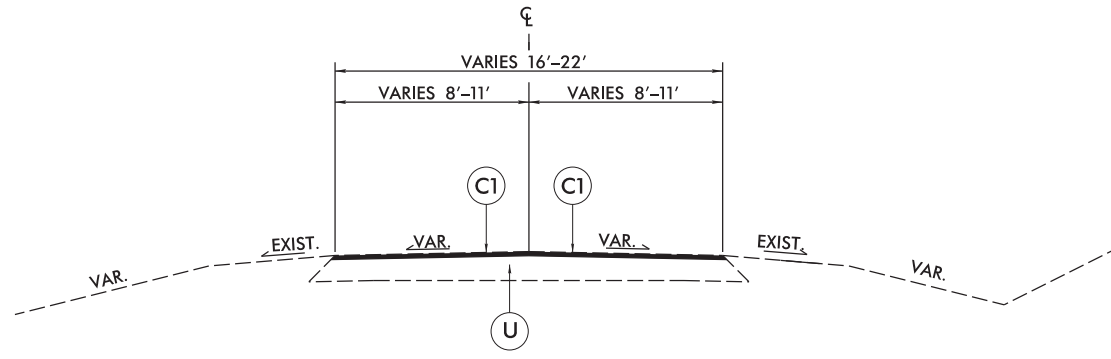

TYPICAL SECTION NO. 1

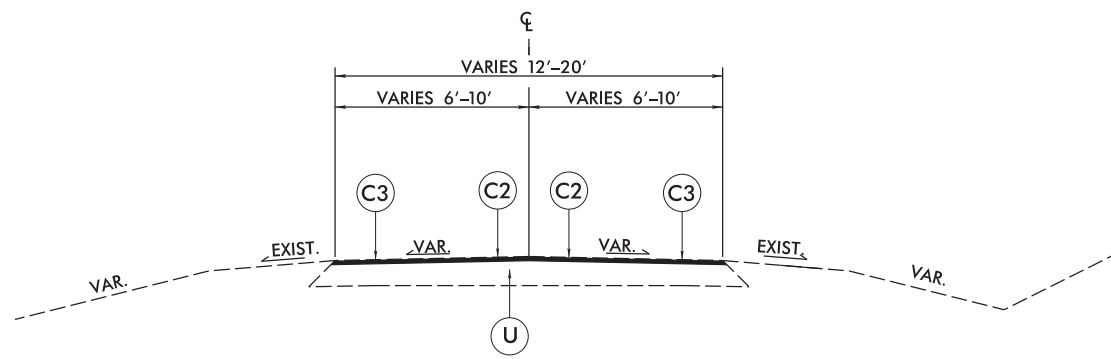

TYPICAL SECTION NO. 2

REVISIONS

8/17/99

1/3/2019  
 I:\District\_3\_TYP\_rdy\_psh.dgn  
 USER:SKENNEDY

PROJECT NO.	SHEET NO.	TOTAL NO.
2019CPT.11.23.20052, 2019CPT.11.23.20972		

### SUMMARY OF QUANTITIES

PROJECT NO	COUNTY	MAP NO	ROUTE	FROM DESCRIPTION	TO DESCRIPTION	TYP NO	LANES	LANE TYPE	LENGTH MI	WIDTH FT	ASPHALT SURFACE TREATMENT, TRIPLE SEAL SY	ASPHALT SURFACE TREATMENT, CAPE SEAL SY	EMULSION FOR ASPHALT SURFACE TREATMENT GAL	VACUUM TRUCK WK	BLOTTING SAND TON
2019CPT.11.23.20052	Ashe	1	SR 1100	SR 1106	SR 1284	2	2.00	2WU	1.23	16.00		11,546	6,350	5	400
2019CPT.11.23.20052	Ashe	2	SR 1105	SR 1103	SR 1106	2	2.00	2WU	0.07	16.00		658	361		
2019CPT.11.23.20052	Ashe	3	SR 1106	SR 1100	SR 1111	2	2.00	2WU	6.09	12.00		42,875	23,580		
2019CPT.11.23.20052	Ashe	4	SR 1111	SR 1112	SR 1106	1	2.00	2WU	4.09	18.00	43,190		34,120		
2019CPT.11.23.20052	Ashe	5	SR 1118	NC 88	SR 1274	1	2.00	2WU	1.97	18.00	20,804		16,435		
2019CPT.11.23.20052	Ashe	6	SR 1145	US 221	SR 1143	1	2.00	2WU	2.86	18.00	30,202		23,860		
2019CPT.11.23.20052	Ashe	7	SR 1171	US 221	EOM	1	2.00	2WU	1.21	20.00	14,198		11,216		
2019CPT.11.23.20052	Ashe	8	SR 1308	SR 1309	TN STATE LN	1	2.00	2WU	1.55	18.00	16,368		12,931		
2019CPT.11.23.20052	Ashe	9	SR 1308	NC 88	SR 1309	1	2.00	2WU	2.80	18.00	29,568		23,359		
2019CPT.11.23.20052	Ashe	10	SR 1322	SR 1326	SR 1325	1	2.00	2WU	1.07	18.00	11,300		8,927		
2019CPT.11.23.20052	Ashe	11	SR 1322	SR 1324	SR 1326	1	2.00	2WU	1.05	18.00	11,088		8,760		
2019CPT.11.23.20052	Ashe	12	SR 1322	SR 1323	SR 1315	1	2.00	2WU	0.41	18.00	4,330		3,421		
2019CPT.11.23.20052	Ashe	13	SR 1323	SR 1322	SR 1389	1	2.00	2WU	1.97	18.00	20,804		16,435		
2019CPT.11.23.20052	Ashe	14	SR 1325	SR 1389	SR 1322	1	2.00	2WU	1.04	18.00	10,982		8,676		
2019CPT.11.23.20052	Ashe	15	SR 1329	SR 1322	SR 1319	1	2.00	2WU	1.50	18.00	15,840		12,514		
2019CPT.11.23.20052	Ashe	16	SR 1332	SR 1339	SR 1334	1	2.00	2WU	1.27	19.00	14,156		11,183		
2019CPT.11.23.20052	Ashe	17	SR 1334	SR 1332	SR 1324	1	2.00	2WU	1.73	18.00	18,269		14,433		
2019CPT.11.23.20052	Ashe	18	SR 1349	SR 1347	NC 194	1	2.00	2WU	1.15	20.00	13,493		10,659		
2019CPT.11.23.20052	Ashe	19	SR 1359	SR 1356	END PVMT	1	2.00	2WU	0.51	19.00	5,685		4,491		
2019CPT.11.23.20052	Ashe	20	SR 1389	SR 1323	SR 1325	1	2.00	2WU	0.97	18.00	10,243		8,092		
2019CPT.11.23.20052	Ashe	21	SR 1536	END PVMT	NC 16	1	2.00	2WU	1.09	18.00	11,510		9,093		
2019CPT.11.23.20052	Ashe	22	SR 1553	SR 1573	END PVMT	1	2.00	2WU	2.19	18.00	23,127		18,270		
2019CPT.11.23.20052	Ashe	23	SR 1575	BEG PVMT	SR 1576	1	2.00	2WU	0.72	18.00	7,603		6,007		
<b>TOTAL FOR PROJ NO. 2019CPT.11.23.20052</b>									<b>38.54</b>		<b>332,760</b>	<b>55,079</b>	<b>293,173</b>	<b>5</b>	<b>400</b>

PROJECT NO.	SHEET NO.	TOTAL NO.
2019CPT.11.23.20052, 2019CPT.11.23.20972		

## SUMMARY OF QUANTITIES

PROJECT NO	COUNTY	MAP NO	ROUTE	FROM DESCRIPTION	TO DESCRIPTION	TYP NO	LANES	LANE TYPE	LENGTH MI	WIDTH FT	ASPHALT SURFACE TREATMENT, TRIPLE SEAL SY	ASPHALT SURFACE TREATMENT, CAPE SEAL SY	EMULSION FOR ASPHALT SURFACE TREATMENT GAL	VACUUM TRUCK WK	BLOTTING SAND TON
2019CPT.11.23.20972	Wilkes	24	SR 1137	NC 268	END PVMT	1	2.00	2WU	0.86	20.00	10,091		7,972		
2019CPT.11.23.20972	Wilkes	25	SR 1211	NC 268	END MAINT	2	2.00	2WU	0.14	20.00		1,645	903		
2019CPT.11.23.20972	Wilkes	26	SR 1226	US 421	CUL-DE-SAC	1	2.00	2WU	0.30	16.00	2,816		2,225		
2019CPT.11.23.20972	Wilkes	27	SR 1243	SR 1180	EOM	1	2.00	2WU	0.15	16.00	1,408		1,112		
2019CPT.11.23.20972	Wilkes	28	SR 1262	NC 268	CUL-DE-SAC	2	2.00	2WU	0.47	18.00		4,964	2,730		
2019CPT.11.23.20972	Wilkes	29	SR 1417	SR 1317	SR 1318	2	2.00	2WU	0.08	20.00		940	516		
2019CPT.11.23.20972	Wilkes	30	SR 1417	SR 1418	DEAD END	2	2.00	2WU	0.09	18.00		950	523		
2019CPT.11.23.20972	Wilkes	31	SR 1418	SR 1417	DEAD END	2	2.00	2WU	0.07	18.00		740	407		
2019CPT.11.23.20972	Wilkes	32	SR 1426	SR 1346	CUL-DE-SAC	2	2.00	2WU	0.30	20.00		3,520	1,936		
2019CPT.11.23.20972	Wilkes	33	SR 1431	NC 16	CUL-DE-SAC	2	2.00	2WU	0.18	20.00		2,114	1,161		
2019CPT.11.23.20972	Wilkes	34	SR 1447	SR 1154	CUL-DE-SAC	1	2.00	2WU	0.21	20.00	2,464		1,947		
2019CPT.11.23.20972	Wilkes	35	SR 1503	NC 18	CUL-DE-SAC	1	2.00	2WU	0.70	20.00	8,213		6,489		
2019CPT.11.23.20972	Wilkes	36	SR 1510	SR 1372	SR 1509	1	2.00	2WU	0.49	18.00	5,174		4,088		
2019CPT.11.23.20972	Wilkes	37	SR 1510	SR 1509	SR 1372	1	2.00	2WU	0.24	20.00	2,816		2,225		
2019CPT.11.23.20972	Wilkes	39	SR 1567	BEG PVMT	SR 1568	1	2.00	2WU	0.69	18.00	7,286		5,756		
2019CPT.11.23.20972	Wilkes	40	SR 1569	SR 1567	END PVMT	1	2.00	2WU	0.98	16.00	9,198		7,267		
2019CPT.11.23.20972	Wilkes	41	SR 1570	SR 1567	SR 1559	1	2.00	2WU	1.73	20.00	20,298		16,035		
2019CPT.11.23.20972	Wilkes	42	SR 1575	NC 18	PVMT CHANGE	1	2.00	2WU	0.99	20.00	11,616		9,177		
2019CPT.11.23.20972	Wilkes	43	SR 1593	SR 1333	EOM	2	2.00	2WU	0.24	20.00		2,818	1,549		
2019CPT.11.23.20972	Wilkes	44	SR 1633	SR 1315	END MAINT	2	2.00	2WU	0.19	16.00		1,785	981		
2019CPT.11.23.20972	Wilkes	45	SR 1703	SR 1718	END 18'PVT	1	2.00	2WU	1.01	18.00	10,666		8,426		
2019CPT.11.23.20972	Wilkes	46	SR 1703	END 18'PVT	SR 1717	1	2.00	2WU	1.36	20.00	15,958		12,607		
2019CPT.11.23.20972	Wilkes	47	SR 1714	SR 1715	SR 1713	1	2.00	2WU	1.17	18.00	12,356		9,761		
2019CPT.11.23.20972	Wilkes	48	SR 1720	NC 18	EOM	1	2.00	2WU	1.00	18.00	10,520		8,311		
2019CPT.11.23.20972	Wilkes	49	SR 1722	SR 1717	SR 1723	1	2.00	2WU	0.97	20.00	11,382		8,992		
2019CPT.11.23.20972	Wilkes	50	SR 1722	SR 1723	NC 18	1	2.00	2WU	1.42	20.00	16,662		13,163		
2019CPT.11.23.20972	Wilkes	51	SR 1724	SR 1725	SR 1715	1	2.00	2WU	0.42	18.00	4,436		3,505		
2019CPT.11.23.20972	Wilkes	52	SR 1725	NC 18	SR 1726	1	2.00	2WU	0.66	18.00	6,970		5,506		
2019CPT.11.23.20972	Wilkes	53	SR 1725	SR 1726	BRIDGE	1	2.00	2WU	3.55	18.00	37,488		29,616		
2019CPT.11.23.20972	Wilkes	55	SR 1725	BRIDGE	SR 1724	1	2.00	2WU	1.18	18.00	12,461		9,844		
2019CPT.11.23.20972	Wilkes	56	SR 1726	SR 1725	SR 1725	1	2.00	2WU	0.47	18.00	4,964		3,922		
2019CPT.11.23.20972	Wilkes	57	SR 1730	SR 1715	BRIDGE	1	2.00	2WU	0.63	20.00	7,392		5,839		
2019CPT.11.23.20972	Wilkes	58	SR 1730	BRIDGE	SR 1002	1	2.00	2WU	1.94	20.00	22,763		17,982		
2019CPT.11.23.20972	Wilkes	59	SR 1781	SR 1002	EOM	2	2.00	2WU	0.37	16.00		3,474	1,911		
2019CPT.11.23.20972	Wilkes	60	SR 1793	SR 1722	CUL-DE-SAC	1	2.00	2WU	0.31	16.00	2,910		2,299		
2019CPT.11.23.20972	Wilkes	61	SR 1798	SR 1002	EOP	1	2.00	2WU	0.18	16.00	1,689		1,335		
2019CPT.11.23.20972	Wilkes	62	SR 1907	SR 1902	SURRY CO	1	2.00	2WU	0.01	18.00	106		84		
2019CPT.11.23.20972	Wilkes	63	SR 1918	SR 1917	SR 1753	1	2.00	2WU	1.38	18.00	14,572		11,512		
2019CPT.11.23.20972	Wilkes	64	SR 1939	SR 2009	SR 1943	1	2.00	2WU	1.63	18.00	17,212		13,598		
2019CPT.11.23.20972	Wilkes	65	SR 1950	SR 1002	END 20' PVMT	1	2.00	2WU	2.00	20.00	23,467		18,539		
2019CPT.11.23.20972	Wilkes	66	SR 1950	END 20' PVMT	EOM	1	2.00	2WU	0.70	18.00	7,392		5,840		
2019CPT.11.23.20972	Wilkes	67	SR 1972	NC 18	EOM	1	2.00	2WU	0.15	22.00	1,936		1,529		
2019CPT.11.23.20972	Wilkes	68	SR 1987	NC 268	SR 1986	1	2.00	2WU	0.47	18.00	4,964		3,922		
2019CPT.11.23.20972	Wilkes	69	SR 1989	NC 268	SR 1992	1	2.00	2WU	1.20	18.00	12,672		10,011		
2019CPT.11.23.20972	Wilkes	70	SR 2017	NC 268	SR 2018	1	2.00	2WU	1.17	18.00	12,356		9,762		
2019CPT.11.23.20972	Wilkes	71	SR 2021	SR 2022	SR 2024	1	2.00	2WU	0.98	18.00	10,348		8,175		
2019CPT.11.23.20972	Wilkes	72	SR 2021	SR 2024	SR 2026	1	2.00	2WU	0.65	16.00	6,101		4,820		
2019CPT.11.23.20972	Wilkes	73	SR 2021	SR 1924	SR 2022	1	2.00	2WU	1.21	18.00	12,778		10,095		
2019CPT.11.23.20972	Wilkes	74	SR 2021	BRIDGE	SR 1924	1	2.00	2WU	0.85	20.00	9,973		7,879		
2019CPT.11.23.20972	Wilkes	75	SR 2021	SR 1934	BRIDGE	1	2.00	2WU	0.53	18.00	5,596		4,421		
2019CPT.11.23.20972	Wilkes	76	SR 2024	SR 2021	SR 1924	1	2.00	2WU	2.13	20.00	24,991		19,743		
2019CPT.11.23.20972	Wilkes	77	SR 2112	SR 1002	CUL-DE-SAC	1	2.00	2WU	0.20	20.00	2,347		1,854		
2019CPT.11.23.20972	Wilkes	78	SR 2123	SR 1957	CUL-DE-SAC	2	2.00	2WU	0.19	20.00		2,232	1,226		
2019CPT.11.23.20972	Wilkes	79	SR 2318	FIRST BRG	SR 2325	1	2.00	2WU	1.43	16.00	13,423		10,604		
2019CPT.11.23.20972	Wilkes	80	SR 2318	SR 2324	SR 2321	1	2.00	2WU	1.19	20.00	13,963		11,030		

PROJECT NO.	SHEET NO.	TOTAL NO.
2019CPT.11.23.20052, 2019CPT.11.23.20972		

### SUMMARY OF QUANTITIES

PROJECT NO	COUNTY	MAP NO	ROUTE	FROM DESCRIPTION	TO DESCRIPTION	TYP NO	LANES	LANE TYPE	LENGTH MI	WIDTH FT	ASPHALT SURFACE TREATMENT, TRIPLE SEAL SY	ASPHALT SURFACE TREATMENT, CAPE SEAL SY	EMULSION FOR ASPHALT SURFACE TREATMENT GAL	VACUUM TRUCK WK	BLOTTING SAND TON
2019CPT.11.23.20972	Wilkes	81	SR 2358	SR 2318	DEAD END	2	2.00	2WU	0.20	16.00		1,878	1,032		
2019CPT.11.23.20972	Wilkes	82	SR 2416	BRIDGE	SR 2400	1	2.00	2WU	0.68	18.00	7,181		5,673		
2019CPT.11.23.20972	Wilkes	83	SR 2563	SR 2462	SR 2564	2	2.00	2WU	0.12	20.00		1,409	771		
2019CPT.11.23.20972	Wilkes	84	SR 2564	CUL-DE-SAC	SR 2575	2	2.00	2WU	0.33	20.00		3,874	2,129		
2019CPT.11.23.20972	Wilkes	85	SR 2571	SR 2564	CUL-DE-SAC	2	2.00	2WU	0.36	20.00		4,224	2,323		
2019CPT.11.23.20972	Wilkes	86	SR 2573	SR 2563	CUL-DE-SAC	2	2.00	2WU	0.04	20.00		472	258		
2019CPT.11.23.20972	Wilkes	87	SR 2575	SR 2462	SR 2564	2	2.00	2WU	0.15	18.00		1,584	872		
2019CPT.11.23.20972	Wilkes	88	SR 2608	NC 268	CUL-DE-SAC	2	2.00	2WU	0.17	18.00		1,796	988		
<b>TOTAL FOR PROJ NO. 2019CPT.11.23.20972</b>									<b>45.86</b>		<b>461,375</b>	<b>40,419</b>	<b>386,708</b>		
<b>GRAND TOTAL</b>									<b>84.40</b>		<b>794,135</b>	<b>95,498</b>	<b>679,881</b>	<b>5</b>	<b>400</b>



PROJECT NO.	SHEET NO.	TOTAL NO.
2019CPT.11.23.20052, 2019CPT.11.23.20972		

**THERMOPLASTIC AND PAINT QUANTITIES**

PROJECT NO	COUNTY	MAP NO	ROUTE	FROM DESCRIPTION	TO DESCRIPTION	TYP NO	LANES	LANE TYPE	LENGTH MI	WIDTH FT	441300000-E	445700000-N	481000000-E	481000000-E	483500000-E	484000000-N
											WORK ZONE ADVANCE/GENERAL WARNING SIGNING SF	TEMPORARY TRAFFIC CONTROL LS	4" WHITE PAINT LF	4" YELLOW PAINT LF	24" WHITE PAINT LF	PAINT PAVEMENT MARKING CHARACTER EA
2019CPT.11.23.20052	Ashe	1	SR 1100	SR 1106	SR 1284	2	2.00	2WU	1.23	16.00	128	1.00	27,878	27,878	20	12
2019CPT.11.23.20052	Ashe	2	SR 1105	SR 1103	SR 1106	2	2.00	2WU	0.07	16.00	64					
2019CPT.11.23.20052	Ashe	3	SR 1106	SR 1100	SR 1111	2	2.00	2WU	6.09	12.00	384		75,610	75,610		
2019CPT.11.23.20052	Ashe	4	SR 1111	SR 1112	SR 1106	1	2.00	2WU	4.09	18.00	256		47,098	47,098		
2019CPT.11.23.20052	Ashe	5	SR 1118	NC 88	SR 1274	1	2.00	2WU	1.97	18.00	128		-	-		
2019CPT.11.23.20052	Ashe	6	SR 1145	US 221	SR 1143	1	2.00	2WU	2.86	18.00	192		-	-		
2019CPT.11.23.20052	Ashe	7	SR 1171	US 221	EOM	1	2.00	2WU	1.21	20.00	128		32,736	32,736		
2019CPT.11.23.20052	Ashe	8	SR 1308	SR 1309	TN STATE LN	1	2.00	2WU	1.55	18.00	128		34,848	34,848		
2019CPT.11.23.20052	Ashe	9	SR 1308	NC 88	SR 1309	1	2.00	2WU	2.80	18.00	192		-	-		
2019CPT.11.23.20052	Ashe	10	SR 1322	SR 1326	SR 1325	1	2.00	2WU	1.07	18.00	64		-	-		
2019CPT.11.23.20052	Ashe	11	SR 1322	SR 1324	SR 1326	1	2.00	2WU	1.05	18.00	64		-	-		
2019CPT.11.23.20052	Ashe	12	SR 1322	SR 1323	SR 1315	1	2.00	2WU	0.41	18.00	64		2,957	2,957		
2019CPT.11.23.20052	Ashe	13	SR 1323	SR 1322	SR 1389	1	2.00	2WU	1.97	18.00	128		-	-		
2019CPT.11.23.20052	Ashe	14	SR 1325	SR 1389	SR 1322	1	2.00	2WU	1.04	18.00	64		18,374	18,374		
2019CPT.11.23.20052	Ashe	15	SR 1329	SR 1322	SR 1319	1	2.00	2WU	1.50	18.00	128		13,094	13,094		
2019CPT.11.23.20052	Ashe	16	SR 1332	SR 1339	SR 1334	1	2.00	2WU	1.27	19.00	128		10,349	10,349		
2019CPT.11.23.20052	Ashe	17	SR 1334	SR 1332	SR 1324	1	2.00	2WU	1.73	18.00	128		25,555	25,555		
2019CPT.11.23.20052	Ashe	18	SR 1349	SR 1347	NC 194	1	2.00	2WU	1.15	20.00	128		-	-		
2019CPT.11.23.20052	Ashe	19	SR 1359	SR 1356	END PVMT	1	2.00	2WU	0.51	19.00	64		-	-		
2019CPT.11.23.20052	Ashe	20	SR 1389	SR 1323	SR 1325	1	2.00	2WU	0.97	18.00	64		32,525	32,525		
2019CPT.11.23.20052	Ashe	21	SR 1536	END PVMT	NC 16	1	2.00	2WU	1.09	18.00	64		-	-		
2019CPT.11.23.20052	Ashe	22	SR 1553	SR 1573	END PVMT	1	2.00	2WU	2.19	18.00	128		4,013	4,013		
2019CPT.11.23.20052	Ashe	23	SR 1575	BEG PVMT	SR 1576	1	2.00	2WU	0.72	18.00	64		-	-		
<b>TOTAL FOR PROJ NO. 2019CPT.11.23.20052</b>									<b>38.54</b>		<b>2,880</b>	<b>1</b>	<b>325,037</b>	<b>325,037</b>	<b>20</b>	<b>12</b>

PROJECT NO.	SHEET NO.	TOTAL NO.
2019CPT.11.23.20052, 2019CPT.11.23.20972		

### THERMOPLASTIC AND PAINT QUANTITIES

PROJECT NO	COUNTY	MAP NO	ROUTE	FROM DESCRIPTION	TO DESCRIPTION	TYP NO	LANES	LANE TYPE	LENGTH MI	WIDTH FT	441300000-E	445700000-N	481000000-E	481000000-E	483500000-E	484000000-N
											WORK ZONE ADVANCE/GENERAL WARNING SIGNING SF	TEMPORARY TRAFFIC CONTROL LS	4" WHITE PAINT LF	4" YELLOW PAINT LF	24" WHITE PAINT LF	PAINT PAVEMENT MARKING CHARACTER EA
2019CPT.11.23.20972	Wilkes	24	SR 1137	NC 268	END PVMT	1	2.00	2WU	0.86	20.00	64		-	-	20	12
2019CPT.11.23.20972	Wilkes	25	SR 1211	NC 268	END MAINT	2	2.00	2WU	0.14	20.00	64		-	-		
2019CPT.11.23.20972	Wilkes	26	SR 1226	US 421	CUL-DE-SAC	1	2.00	2WU	0.30	16.00	64		9,082	9,082		
2019CPT.11.23.20972	Wilkes	27	SR 1243	SR 1180	EOM	1	2.00	2WU	0.15	16.00	64		33,370	33,370		
2019CPT.11.23.20972	Wilkes	28	SR 1262	NC 268	CUL-DE-SAC	2	2.00	2WU	0.47	18.00	64		25,133	25,133		
2019CPT.11.23.20972	Wilkes	29	SR 1417	SR 1317	SR 1318	2	2.00	2WU	0.08	20.00	64		28,301	28,301		
2019CPT.11.23.20972	Wilkes	30	SR 1417	SR 1418	DEAD END	2	2.00	2WU	0.09	18.00	64		13,939	13,939		
2019CPT.11.23.20972	Wilkes	31	SR 1418	SR 1417	DEAD END	2	2.00	2WU	0.07	18.00	64		-	-		
2019CPT.11.23.20972	Wilkes	32	SR 1426	SR 1346	CUL-DE-SAC	2	2.00	2WU	0.30	20.00	64		9,293	9,293		
2019CPT.11.23.20972	Wilkes	33	SR 1431	NC 16	CUL-DE-SAC	2	2.00	2WU	0.18	20.00	64		22,176	22,176		
2019CPT.11.23.20972	Wilkes	34	SR 1447	SR 1154	CUL-DE-SAC	1	2.00	2WU	0.21	20.00	64		24,288	24,288		
2019CPT.11.23.20972	Wilkes	35	SR 1503	NC 18	CUL-DE-SAC	1	2.00	2WU	0.70	20.00	64		13,094	13,094		
2019CPT.11.23.20972	Wilkes	36	SR 1510	SR 1372	SR 1509	1	2.00	2WU	0.49	18.00	64		35,060	35,060		
2019CPT.11.23.20972	Wilkes	37	SR 1510	SR 1509	SR 1372	1	2.00	2WU	0.24	20.00	64		25,133	25,133		
2019CPT.11.23.20972	Wilkes	39	SR 1567	BEG PVMT	SR 1568	1	2.00	2WU	0.69	18.00	64		-	-		
2019CPT.11.23.20972	Wilkes	40	SR 1569	SR 1567	END PVMT	1	2.00	2WU	0.98	16.00	64		-	-		
2019CPT.11.23.20972	Wilkes	41	SR 1570	SR 1567	SR 1559	1	2.00	2WU	1.73	20.00	128		-	-		
2019CPT.11.23.20972	Wilkes	42	SR 1575	NC 18	PVMT CHANGE	1	2.00	2WU	0.99	20.00	64		11,194	11,194		
2019CPT.11.23.20972	Wilkes	43	SR 1593	SR 1333	EOM	2	2.00	2WU	0.24	20.00	64		-	-		
2019CPT.11.23.20972	Wilkes	44	SR 1633	SR 1315	END MAINT	2	2.00	2WU	0.19	16.00	64		-	-		
2019CPT.11.23.20972	Wilkes	45	SR 1703	SR 1718	END 18'PVT	1	2.00	2WU	1.01	18.00	64		-	-		
2019CPT.11.23.20972	Wilkes	46	SR 1703	END 18'PVT	SR 1717	1	2.00	2WU	1.36	20.00	128		5,914	5,914		
2019CPT.11.23.20972	Wilkes	47	SR 1714	SR 1715	SR 1713	1	2.00	2WU	1.17	18.00	128		-	-		
2019CPT.11.23.20972	Wilkes	48	SR 1720	NC 18	EOM	1	2.00	2WU	1.00	18.00	64		-	-		
2019CPT.11.23.20972	Wilkes	49	SR 1722	SR 1717	SR 1723	1	2.00	2WU	0.97	20.00	64		17,741	17,741		
2019CPT.11.23.20972	Wilkes	50	SR 1722	SR 1723	NC 18	1	2.00	2WU	1.42	20.00	128		13,094	13,094		
2019CPT.11.23.20972	Wilkes	51	SR 1724	SR 1725	SR 1715	1	2.00	2WU	0.42	18.00	64		19,432	19,432		
2019CPT.11.23.20972	Wilkes	52	SR 1725	NC 18	SR 1726	1	2.00	2WU	0.66	18.00	64		-	-		
2019CPT.11.23.20972	Wilkes	53	SR 1725	SR 1726	BRIDGE	1	2.00	2WU	3.55	18.00	256		22,598	22,598		
2019CPT.11.23.20972	Wilkes	55	SR 1725	BRIDGE	SR 1724	1	2.00	2WU	1.18	18.00	128		30,413	30,413		
2019CPT.11.23.20972	Wilkes	56	SR 1726	SR 1725	SR 1725	1	2.00	2WU	0.47	18.00	64		8,870	8,870		
2019CPT.11.23.20972	Wilkes	57	SR 1730	SR 1715	BRIDGE	1	2.00	2WU	0.63	20.00	64		18,797	18,797		
2019CPT.11.23.20972	Wilkes	58	SR 1730	BRIDGE	SR 1002	1	2.00	2WU	1.94	20.00	128		29,568	29,568		
2019CPT.11.23.20972	Wilkes	59	SR 1781	SR 1002	EOM	2	2.00	2WU	0.37	16.00	64		28,090	28,090		
2019CPT.11.23.20972	Wilkes	60	SR 1793	SR 1722	CUL-DE-SAC	1	2.00	2WU	0.31	16.00	64		18,163	18,163		
2019CPT.11.23.20972	Wilkes	61	SR 1798	SR 1002	EOP	1	2.00	2WU	0.18	16.00	64		9,293	9,293		
2019CPT.11.23.20972	Wilkes	62	SR 1907	SR 1902	SURRY CO	1	2.00	2WU	0.01	18.00	64		4,435	4,435		
2019CPT.11.23.20972	Wilkes	63	SR 1918	SR 1917	SR 1753	1	2.00	2WU	1.38	18.00	128		-	-		
2019CPT.11.23.20972	Wilkes	64	SR 1939	SR 2009	SR 1943	1	2.00	2WU	1.63	18.00	128		11,405	11,405		
2019CPT.11.23.20972	Wilkes	65	SR 1950	SR 1002	END 20' PVMT	1	2.00	2WU	2.00	20.00	128		-	-		
2019CPT.11.23.20972	Wilkes	66	SR 1950	END 20' PVMT	EOM	1	2.00	2WU	0.70	18.00	64		-	-		
2019CPT.11.23.20972	Wilkes	67	SR 1972	NC 18	EOM	1	2.00	2WU	0.15	22.00	64		-	-		
2019CPT.11.23.20972	Wilkes	68	SR 1987	NC 268	SR 1986	1	2.00	2WU	0.47	18.00	64		-	-		
2019CPT.11.23.20972	Wilkes	69	SR 1989	NC 268	SR 1992	1	2.00	2WU	1.20	18.00	128		-	-		
2019CPT.11.23.20972	Wilkes	70	SR 2017	NC 268	SR 2018	1	2.00	2WU	1.17	18.00	128		16,474	16,474		
2019CPT.11.23.20972	Wilkes	71	SR 2021	SR 2022	SR 2024	1	2.00	2WU	0.98	18.00	64		21,120	21,120		
2019CPT.11.23.20972	Wilkes	72	SR 2021	SR 2024	SR 2026	1	2.00	2WU	0.65	16.00	64		16,051	16,051		
2019CPT.11.23.20972	Wilkes	73	SR 2021	SR 1924	SR 2022	1	2.00	2WU	1.21	18.00	128		2,323	2,323		
2019CPT.11.23.20972	Wilkes	74	SR 2021	BRIDGE	SR 1924	1	2.00	2WU	0.85	20.00	64		-	-		

PROJECT NO.	SHEET NO.	TOTAL NO.
2019CPT.11.23.20052, 2019CPT.11.23.20972		

**THERMOPLASTIC AND PAINT QUANTITIES**

PROJECT NO	COUNTY	MAP NO	ROUTE	FROM DESCRIPTION	TO DESCRIPTION	TYP NO	LANES	LANE TYPE	LENGTH MI	WIDTH FT	4413000000-E	4457000000-N	4810000000-E	4810000000-E	4835000000-E	4840000000-N	
											WORK ZONE ADVANCE/GENERAL WARNING SIGNING	TEMPORARY TRAFFIC CONTROL	4" WHITE PAINT	4" YELLOW PAINT	24" WHITE PAINT	PAINT PAVEMENT MARKING CHARACTER EA	
												SF	LS	LF	LF	LF	
2019CPT.11.23.20972	Wilkes	75	SR 2021	SR 1934	BRIDGE	1	2.00	2WU	0.53	18.00	64		14,784	14,784	20	12	
2019CPT.11.23.20972	Wilkes	76	SR 2024	SR 2021	SR 1924	1	2.00	2WU	2.13	20.00	128		-	-			
2019CPT.11.23.20972	Wilkes	77	SR 2112	SR 1002	CUL-DE-SAC	1	2.00	2WU	0.20	20.00	64		25,133	25,133			
2019CPT.11.23.20972	Wilkes	78	SR 2123	SR 1957	CUL-DE-SAC	2	2.00	2WU	0.19	20.00	64		33,370	33,370			
2019CPT.11.23.20972	Wilkes	79	SR 2318	FIRST BRG	SR 2325	1	2.00	2WU	1.43	16.00	128		23,443	23,443			
2019CPT.11.23.20972	Wilkes	80	SR 2318	SR 2324	SR 2321	1	2.00	2WU	1.19	20.00	128		19,642	19,642			
2019CPT.11.23.20972	Wilkes	81	SR 2358	SR 2318	DEAD END	2	2.00	2WU	0.20	16.00	64		28,301	28,301			
2019CPT.11.23.20972	Wilkes	82	SR 2416	BRIDGE	SR 2400	1	2.00	2WU	0.68	18.00	64		19,853	19,853			
2019CPT.11.23.20972	Wilkes	83	SR 2563	SR 2462	SR 2564	2	2.00	2WU	0.12	20.00	64		-	-			
2019CPT.11.23.20972	Wilkes	84	SR 2564	CUL-DE-SAC	SR 2575	2	2.00	2WU	0.33	20.00	64		17,741	17,741			
2019CPT.11.23.20972	Wilkes	85	SR 2571	SR 2564	CUL-DE-SAC	2	2.00	2WU	0.36	20.00	64		1,901	1,901			
2019CPT.11.23.20972	Wilkes	86	SR 2573	SR 2563	CUL-DE-SAC	2	2.00	2WU	0.04	20.00	64		40,973	40,973			
2019CPT.11.23.20972	Wilkes	87	SR 2575	SR 2462	SR 2564	2	2.00	2WU	0.15	18.00	64		34,214	34,214			
2019CPT.11.23.20972	Wilkes	88	SR 2608	NC 268	CUL-DE-SAC	2	2.00	2WU	0.17	18.00	64		5,914	5,914			
<b>TOTAL FOR PROJ NO. 2019CPT.11.23.20972</b>									<b>45.86</b>		<b>5,184</b>	<b>1</b>	<b>809,113</b>	<b>809,113</b>	<b>20</b>	<b>12</b>	

<b>GRAND TOTAL</b>									<b>84.40</b>		<b>8,064</b>	<b>1</b>	<b>1,134,150</b>	<b>1,134,150</b>	<b>40</b>	<b>24</b>
--------------------	--	--	--	--	--	--	--	--	--------------	--	--------------	----------	------------------	------------------	-----------	-----------

## SIGNING FOR ASPHALT SURFACE TREATMENT

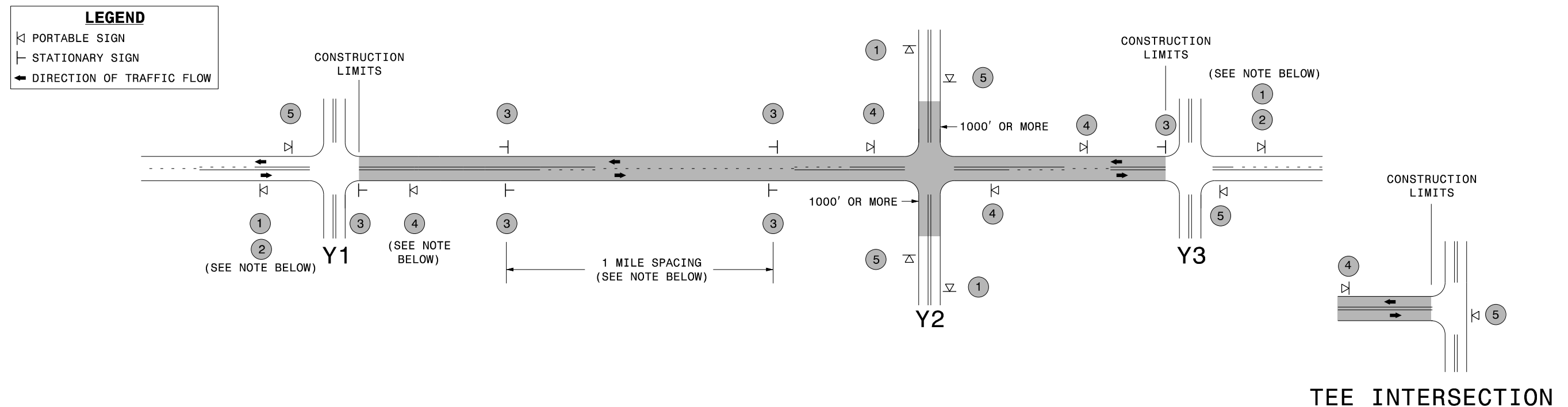

### MAINLINE (-L-) SIGNING

### -Y- LINE SIGNING

<b>SIGNING NOTES AND PLACEMENT PER DIRECTION</b>	1	 	<ul style="list-style-type: none"> <li>- PLACE 1000' PRIOR TO BEGINNING OF CONSTRUCTION LIMITS. ONLY USED ON -Y- LINES IF RESURFACING LIMITS EXTEND 1000' ALONG -Y- LINE.</li> <li>- SIGN #2 ONLY USED WHEN RESURFACING LIMITS ARE 2 OR MORE MILES IN LENGTH. ROUND UP TO THE NEAREST WHOLE NUMBER. DO NOT USE FRACTIONAL OR DECIMAL NUMBERS.</li> </ul>	<p><b>STATIONARY SIGNING NOT REQUIRED FOR THE FOLLOWING -Y- LINE CONDITIONS:</b></p> <ol style="list-style-type: none"> <li>1) LESS THAN 1000' OF RESURFACING ALONG -Y- LINE</li> <li>2) SUBDIVISION ROADS</li> <li>3) DEAD END ROADS</li> </ol> <p>WHEN PAVING/CONSTRUCTION ACTIVITIES PROCEED ACROSS AN UNSIGNED -Y- LINE, PORTABLE ADVANCE WARNING SIGNS SHALL BE USED ALONG THE -Y- LINE AS SHOWN BELOW. REMOVE UPON COMPLETION OF WORK.</p> <div style="display: flex; justify-content: space-around; align-items: center;"> <div style="text-align: center;">   <small>W20-1 48" X 48"</small>              PLACED 500' IN ADVANCE OF FLAGGER.         </div> <div style="text-align: center;">   <small>W20-7 A 48" X 48"</small>              PLACED 250' IN ADVANCE OF FLAGGER.         </div> </div>
	3	 	<ul style="list-style-type: none"> <li>- ALTERNATE THE FOLLOWING TWO SIGNS:</li> <li>- STARTING WITH "LOOSE GRAVEL" (W8-7) FOLLOWED BY "UNMARKED PAVEMENT".</li> <li>- PLACE INITIALLY AT THE CONSTRUCTION LIMITS AND SPACED 1 MILE APART THEREAFTER.</li> <li>- AT TEE INTERSECTIONS INSTALL INITIALLY 0.5 MILE FROM INTERSECTION AND SPACE 1 MILE APART THEREAFTER.</li> </ul>	
	4		<ul style="list-style-type: none"> <li>- THESE ARE FOR -Y- LINES THAT ARE "THROUGH" ROADWAYS. DEAD END AND SUBDIVISION ROADS ARE NOT "THROUGH" ROADWAYS.</li> <li>- INSTALL 500' +/- FROM EACH -Y- LINE APPROACH AS SHOWN ABOVE.</li> <li>- FOR MULTIPLE -Y- LINES THAT ARE SEPARATED BY 0.25 MILES OR LESS, TREAT AS A SINGLE UNIT AND INSTALL WITHIN 500' OF EACH APPROACH.</li> <li>- A MAXIMUM OF 2 SIGN SETS PER MILE. DO NOT INSTALL WHEN -Y- LINES ARE WITHIN 0.5 MILES FROM "END ROAD WORK" SIGN.</li> </ul>	
	5		<ul style="list-style-type: none"> <li>- PLACE 500' FOLLOWING THE END OF CONSTRUCTION LIMITS OR AS SHOWN WHEN WORK ENDS AT A 3-WAY TEE INTERSECTION.</li> </ul>	
	<p>THE ABOVE SIGNS ARE ALL THAT ARE REQUIRED FOR A CONTRACTOR TO BEGIN A RESURFACING CONTRACT. ANY ADDITIONAL SIGNS REQUESTED BY NCDOT DIVISIONS SHALL BE INSTALLED WITHIN 7 BUSINESS DAYS OF THE START OF CONTRACT WORK.</p>			

**MAPS LESS THAN 2 MILES**

FOR AST RESURFACING MAPS WITH CONSTRUCTION LIMITS LESS THAN 2 MILES IN LENGTH, USE A STATIONARY "LOOSE GRAVEL" SIGN AT THE BEGINNING CONSTRUCTION LIMIT FOLLOWED BY AN "UNMARKED PAVEMENT" SIGN MIDWAY THROUGH AND AN "END ROAD WORK" SIGN AT THE END CONSTRUCTION LIMIT.

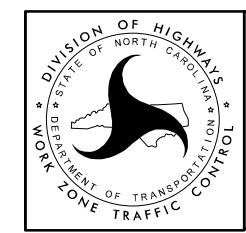

**ADVANCE WARNING SIGNS FOR 2-LANE ROADWAY ASPHALT SURFACE TREATMENT**